



QUICK START GUIDE

THANK YOU FOR PURCHASING YOUR NEW EUREKA VACUUM!

AS1100-1109 Series
With cord rewind

Please take a few moments to read this Quick Start Guide. It is designed to help you assemble your vacuum easily.

To view our "How to Assemble" demo, visit www.eureka.com/suctionseal/assembly

If you have questions about your new vacuum, please contact our customer service helpline at **1-800-282-2886**. We're here to help!

Helpline Hours:

8 a.m. to 7:30 p.m. (CST), Monday - Friday

10 a.m. to 6:30 p.m. (CST), Saturday - Sunday

eureka!
Invented for the way you clean™

STEP 1

What's in the carton

No screws or tools required!

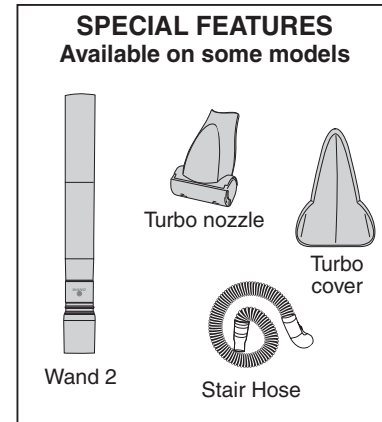
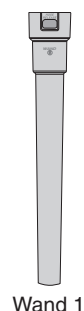
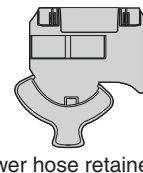
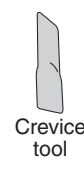
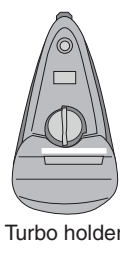
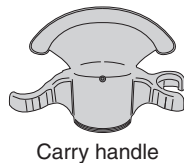
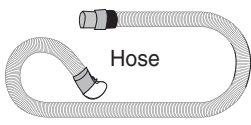
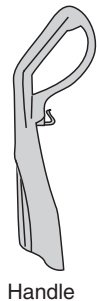
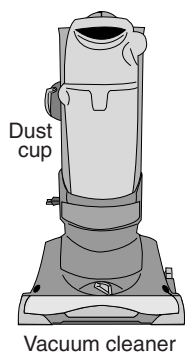

STEP 2

Easy assembly

PLEASE READ ALL INSTRUCTIONS BEFORE USING THIS VACUUM CLEANER.
Moving parts! Assemble the vacuum cleaner before using.

Follow 1-11 in order to ensure proper assembly.

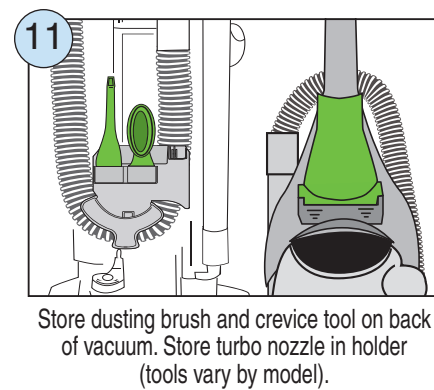
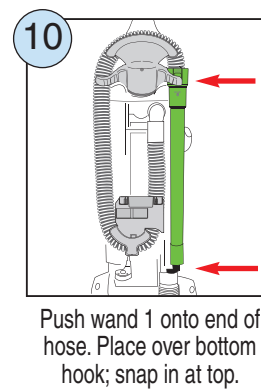
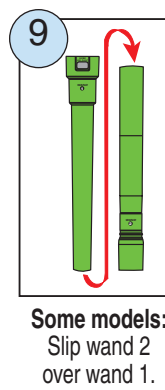
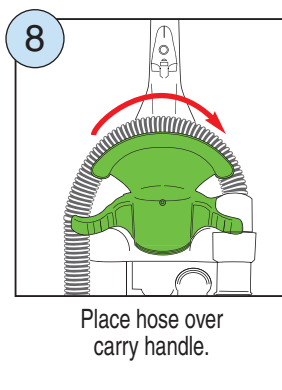
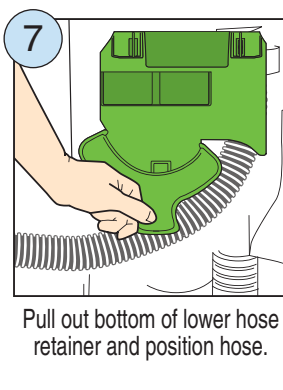
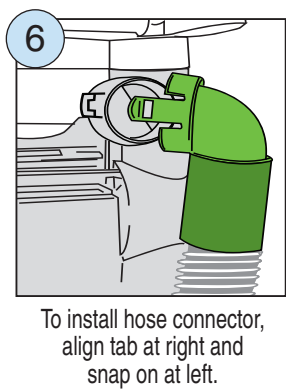
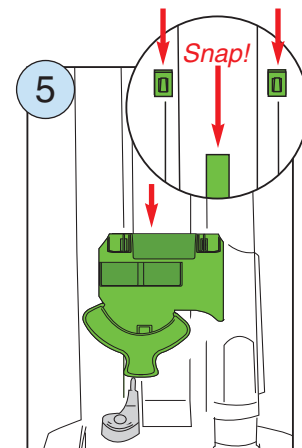
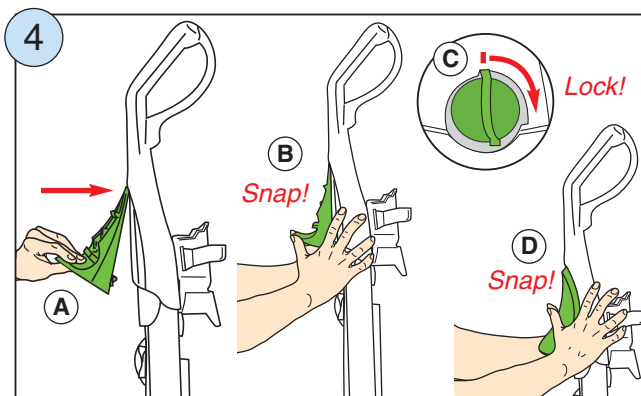
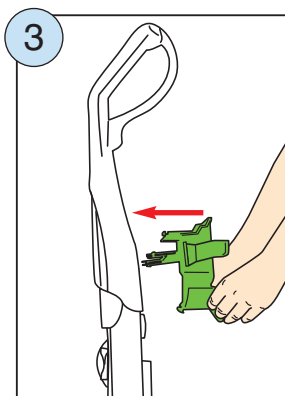
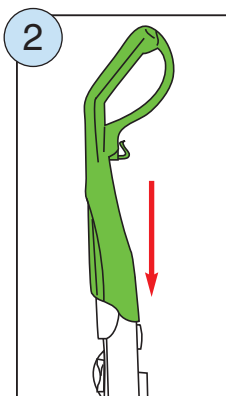
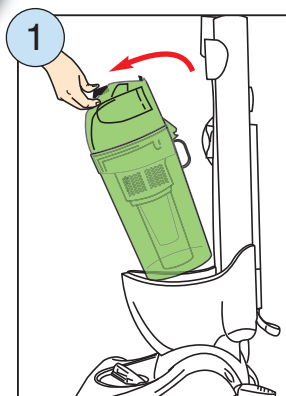

STEP 3

How to use and clean your vacuum

Power switch is marked **Ⓛ** for on-off.

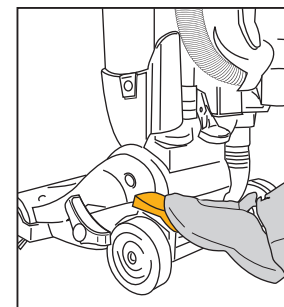
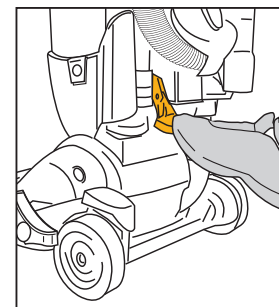
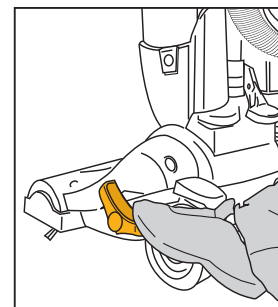
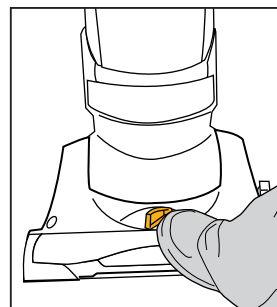
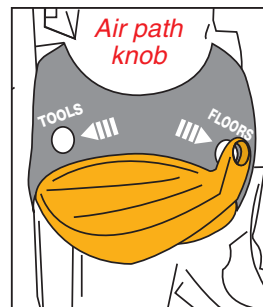
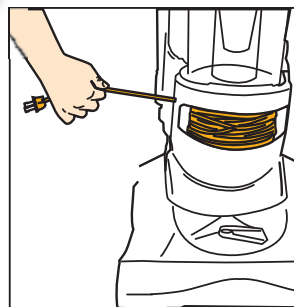

Empty dust cup after each use.

